

7. Historical data. Explain the historical/architectural importance of this area.

The area around Berkeley Street was part of a thirty-seven acre parcel acquired in 1843 by Professor Joseph Worcester. In 1852 Worcester laid out part of Berkeley and Buckingham Streets and all of Craigie Street and began selling house lots.

Despite its being developed by different owners, Berkeley Street has a splendid urban unity and contains the best concentration of Bracketed and Mansard houses in the city. Of the street's eighteen houses, twelve date from between 1852 and 1873. The few Queen Anne houses erected later in large side yards are in keeping with the mass and siting of the earlier works; so is the extremely well-designed stucco house (1905) at Number 16. Two houses, Numbers 12 and 15, have been altered, but retain much original trim.

1. Pryor-Brown House (1852; c.1900, c.1915), 1 Berkeley Street. This greatly remodelled Bracketed Italianate house was built by Dr. Pryor, a Baptist pastor. subsequent occupants included Albert Brown, secretary to Governor Andrew during the Civil War.
2. Richard Henry Dana House (1852), 4 Berkeley Street. A large and elaborate Bracketed Italianate structure which was the home of Richard Henry Dana, author of Two Years Before the Mast.
3. 6 Berkeley Street (1853). This excellent example of a suburban house of the 1850's was built by Moses and Jedediah Ricker ~~for~~ Miss Catherine Donnison. Its low-pitched gables and heavy modillion brackets are characteristic of the Bracketed Italianate style.
4. Wyeth-Allen House (1854), 5 Berkeley Street. The architect Calvin Ryder designed this fine example of a suburban Italianate house. The house was built by Jonas Wyeth III for the Misses Lyman who had a school for young ladies in it. By 1857 Wyeth and his family were living there. It is a classic example of a mid-nineteenth century, T-plan Italianate residence.

8. Bibliography and/or references such as local histories, deeds, assessor's records, early maps, etc.

INVENTORY FORM CONTINUATION SHEET

MASSACHUSETTS HISTORICAL COMMISSION
Office of the Secretary, Boston

Page 2

Community:	Form No:
Old Cambridge	OC I.3
Property Name: Berkeley Street N.R.D.	

Indicate each item on inventory form which is being continued below.

5. 19 Berkeley Street (1855). Notable features of this Bracketed Italianate house include its pedimented gable, arched windows, quoins and front porch with arched and corbelled architrave. It was built for Charles Folsom, a brother-in-law of Professor Worcester who laid out part of Berkeley Street.
6. 21 Berkeley Street (1855). This Bracketed Italianate residence is distinguished by its gabled central pavilion. It was built for Charles Vaughan, whose son arranged for a wooden boardwalk on Berkeley Street, at that time unpaved and muddy.
7. Pryor-Howells House (1857), 3 Berkeley Street. Dr. Pryor also built this smaller more modest house and he and his wife lived there for some years. In 1872 William Dean Howells and his wife rented the house and liked it so much that they built one on the same plan on Concord Avenue.
8. William Newell House (1857), 20 Berkeley Street. This early Mansard house was built for Dr. William Newell, pastor of the Unitarian Church in Harvard Square. Noteworthy features of the house are the elaborate paired brackets, corner quoins and low concave Mansard roof.
9. Henry Ware House (1860), 8 Berkeley Street. Builder Oliver Hastings constructed this Mansard house for Henry Ware. Ware was Secretary to Governors Andrew and Bullock, and Secretary to the Senate in Washington. He helped found the first permanent symphony orchestra in Boston, the forerunner of the present Boston Symphony Orchestra.
10. Lyman Williston House (1863), 15 Berkeley Street. This much-altered house is Old Cambridge's only textbook example of an "Italian Villa." Erected for Lyman Williston, the asymmetrical plan and towered silhouette are typical of the villa form. A one-story wing housed the Berkeley Street School which Mr. Williston directed. It was later detached and remodelled into a separate dwelling at Number 17.
11. 17 Berkeley Street (1863). This structure was originally an ell of the house next door at Number 15. It was detached in 1900 with alterations made at that time by Dwight & Chandler, and again in 1912 by the firm of Kilham & Hopkins.
12. John Fiske House (1878), 22 Berkeley Street. This Mansard house was designed by Griffith Thomas. It was the home of historian John Fiske (1842-1901), an active promoter of Darwin's theory of evolution and librarian of Harvard College from 1872-1879.

Staple to Inventory form at bottom

INVENTORY FORM CONTINUATION SHEET

MASSACHUSETTS HISTORICAL COMMISSION
Office of the Secretary, Boston

Page 3

Community: Old Cambridge	Form No: OC I.3.
Property Name: Berkeley St. N.R.D	

Indicate each item on inventory form which is being continued below.

13. 12 Berkeley Street (1882). This Queen Anne/Shingle Style house, although stuccoed over, retains much of its original trim. A fine triple window indicates the stair landing; the half timbered front porch dates c.1920.
14. John Allyn House (1886), 11 Berkeley Street. This unusually well-preserved Queen Anne/Shingle Style house was designed by architect William Ralph Emerson for John Allyn, who established the publishing firm of Allyn & Bacon.
15. 13 Berkeley Street (1898). The architectural firm of Dwight & Chandler designed this late Queen Anne/Shingle Style house.

The Berkeley Street National Register District includes properties on both sides of Berkeley Street between Craigie Street and Phillips Place (see Cambridge Community Development P. D. Quad Maps 9, 11 & 12). The boundaries were chosen to include houses and lots maintaining the spacing and style of the street's nineteenth century appearance.

-END-

Staple to Inventory form at bottom

Berkeley Street Historic District, Cambridge (Middlesex Co.), MA



1 Berkeley St



12 Berkeley St



5 Berkeley St



22 Berkeley St

United States Department of the Interior
National Park Service

National Register of Historic Places
Inventory—Nomination Form

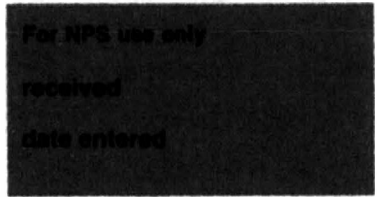

Continuation sheet

Item number

Page 2417

Multiple Resource Area
Thematic Group

Name Cambridge Multiple Resource Area
State MA

Nomination/Type of Review

Date/Signature

- ✓ 11. Garfield Street Historic District
Substantive Review
Keeper *Bruce Lee Poiger 6/30/83*
Attest *Harvard*
- ✓ 12. Harvard Street Historic District
Substantive Review
Keeper *William H. Brahan 4.13.82*
Attest _____
- Result* ✓ 13. Kirkland Place Historic District
Substantive Review
Keeper *Patrick Adams 5/19/86*
Attest *Pat J. Sweeney 5-14-86*
- ✓ 14. Maple Avenue Historic District
Substantive Review
Keeper *Bruce Lee Poiger 6/30/83*
Attest _____
- ✓ 15. City Hall Historic District
Substantive Review
Keeper *William H. Brahan 4.13.82*
Attest _____
- ✓ 16. Ash Street Historic District
Substantive Review
Keeper *William H. Brahan 4.13.82*
Attest _____
- ✓ 17. Avon Hill Historic District
Substantive Review
Keeper *Bruce Lee Poiger 6.30.83*
Attest *Return 4.13.82*
- ✓ 18. Berkeley Street Historic District
Substantive Review
Keeper *William H. Brahan 4.13.82*
Attest _____
- ✓ 19. Cambridge Common Historic District
Substantive Review
Keeper *Bruce Lee Poiger 6.30.83*
Attest *- Harvard*
- ✓ 20. Gold Coast Historic District
Substantive Review
Keeper *Pat 6/10/82*
Attest *Harvard*

APR 4 1986

FORM A - AREA

MASSACHUSETTS HISTORICAL COMMISSION
294 Washington Street, Boston, MA. 02108

Form numbers in this area	Area letter
	I 3
	OLD CAM.

USGS Map = BS



Town Cambridge, Mass.
Cambridge MRA

Name of area (if any) Berkeley Street

and Berkeley Place Historic District
(Boundary Increase)

General date or period 1850-1936

Sketch map. Draw a general map of the area indicating properties within it. Number each property for which individual inventory forms have been completed. Label streets (including route numbers, if any) and indicate north. (Attach a separate sheet if space here is not sufficient)

SEE ATTACHED MAP

USGS Quads: Boston North and Lexington

7.191 acres

Recorded by B. Bunting/T. Aldine

Utm's A-19/325080/4693630
B-19/325020/4693620
C-19/324880/4693680
D-19/324820/4693620
E-19/324740/4693670

Organization Cambridge Hist. Com.

Date 1965/1985

F-19/324940/4693840 H-19/325100/4693720

(Staple additional sheets here)

ARCHITECTURAL SIGNIFICANCE of area. (Describe physical setting, general character, and architecturally significant structures).

Berkeley Street, cut off from through traffic and insulated by brick buildings, enjoys a great sense of isolation from the urban environment. Berkeley Place, a cul-de-sac, is even quieter than Berkeley Street. The spacious lots and high proportion of high style Mansard and Bracketed Italianate houses make this district one of the most distinguished in Cambridge.

Berkeley Street contains many variants of the Bracketed Italianate style. Three examples of the mid-nineteenth century T-shaped plan, 4, 5 and 6 Berkeley Street establish the suburban mode of the street. One-story porches fill the angles of the T. Other Italianate features include low-pitched gables, heavy modillion brackets under the eaves and round headed windows.

Square in plan, 19 and 21 Berkeley Street offer other Bracketed
HISTORICAL SIGNIFICANCE of area. (Explain development of area, what caused it, and how it affected community; be specific). Continued

The area around Berkeley Street was part of a thirty-seven acre parcel acquired in 1843 by Professor Joseph Worcester from the Vassall-Craigie estate. By 1852, Worcester had laid out part of Berkeley and Buckingham Streets and all of Craigie Street and began selling lots for expensive houses. Berkeley Place, which provided ingress to the back field of the Worcester home lot at 121 Brattle Street, was laid out in 1890.

Despite being developed by different owners, the district retains a splendid urban unity and contains the best concentration of Bracketed Italianate and Mansard houses in Cambridge. The few Queen Anne and Stucco Style houses erected later in large side yards and on Berkeley Place are in keeping with the mass and siting of the earlier works.

Several houses in the district had prominent owners. The Richard Henry Dana House (1851) at 4 Berkeley Street, a large and elaborate Bracketed Italianate structure, was the home of Richard Henry Dana, author of Two Years Before the Mast. The John Fiske House (1878), at 22 Berkeley Street was the home of John Fiske (1842-1901), an active promoter of Darwin's theory of evolution and librarian of Harvard College from 1872-1879. Finally, 8 Berkeley Street was the home of Henry Ware, Secretary to Governors Andrew and Bullock, and Secretary to the Senate in Washington. He also helped to found the first permanent symphony orchestra in Boston, the forerunner of the present Boston Symphony Orchestra.

BIBLIOGRAPHY and/or REFERENCES

Continued

SEE ATTACHED BIBLIOGRAPHY

INVENTORY FORM CONTINUATION SHEET

MASSACHUSETTS HISTORICAL COMMISSION
Office of the Secretary, Boston

Community: Cambridge Mass. Cambridge MRA	Form No: I 3
Property Name: Berkeley St. & Pl	

Indicate each item on inventory form which is being continued below.

Architectural Significance con't.

examples. 19 Berkeley Street features corner quoins, a pedimented gable with arched windows on its side elevations and a front porch with arched windows and corbelled architrave. Number 21 Berkeley Street's most distinguishing characteristic is its gabled central pavilion.

A third Italianate form, the "Italian Villa", is also represented on Berkeley Street. Cambridge's only textbook example of this villa form stands at number 15 and features an asymmetrical plan and tower.

Representing the Mansard style is 20 Berkeley Street. Except for its roof which has simple dormers, this early Mansard, with its corner quoins, heavy paired eaves brackets and center porch, resembles the gabled Italianate house at 19 Berkeley Street. Other Mansards include 22 Berkeley Street which features a flushboarded facade and number 8 designed by Oliver Hastings, a prominent Cambridge architect.

The Queen Anne/Shingle Style is represented by 11, 12 and 13 Berkeley Street, and 3 Berkeley Place. The best developed and well-preserved of these, 11 Berkeley Street was designed by architect William Ralph Emerson. Typical Shingle Style details include rounded corners which preserve the continuity of the shingled surface and a unified roof line.

Representing the 20th Century are two Stucco Style houses at 16 Berkeley Street and 7 Berkeley Place by Hartley Dennett and A.W. Jackson respectively. The overhanging eaves with brackets, slate roof and varied fenestration help these buildings fit in well with their nineteenth century neighbors.

Berkeley Street and Berkeley Place are significant under Criterion C as embodying the distinguishing characteristics of the Bracketed Italianate, Mansard and Shingle styles.

Staple to Inventory form at bottom.

INVENTORY FORM CONTINUATION SHEET

MASSACHUSETTS HISTORICAL COMMISSION
Office of the Secretary, Boston

Community: Cambridge Mass. Cambridge MRA	Form No: I 3
Property Name: Berkeley St. & Pl. N R D	

Indicate each item on inventory form which is being continued below.

Criteria For Evaluation

The Berkeley Street and Berkeley Place National Register District is significant as a nineteenth and early twentieth century residential neighborhood in a fine state of preservation. Most of the early houses on Berkeley Street are large well-maintained examples of the Italianate style. The houses on Berkeley Place were built after 1890, but are consistent in scale and materials with those on Berkeley Street. Both streets retain their integrity of location, design, setting, material, feeling and workmanship, and fulfill Criterion C of the National Register of Historic Places. The district is also significant under Criterion B for its associations with people in the fields of literature and education. The Berkeley Street and Berkeley Place National Register District was found to be significant under the themes of residential architecture: nineteenth and early twentieth century, education, and literature, as proposed by Dr. Cynthia to the Review Committee for the Study of Architecture of Harvard University and its Environs in Cambridge.

Berkeley Street is a quiet residential street cut off from through traffic. Berkeley Place, being a cul-de-sac, is even more peaceful than Berkeley Street. Berkeley Street possesses great architectural unity and a large proportion of high style buildings. The houses on Berkeley Place, though later in date, are similar in their high degree of architectural quality.

The boundaries of the Berkeley Street and Berkeley Place National Register District include all addresses on these streets except 10 and 11 Berkeley Place. The boundaries were drawn to include houses and lots maintaining the spacing and style of the streets' nineteenth century appearance. The district is insulated to the south by the brick complex of the Episcopal Theological School, and to the north by several apartment buildings along Concord Avenue.

The only building that does not contribute to the district, at 24 Berkeley Street, is an un-distinguished house of vaguely Colonial Revival style. It is included so as to include the entire length of Berkeley Street in the district.

Staple to Inventory form at bottom

INVENTORY FORM CONTINUATION SHEET

MASSACHUSETTS HISTORICAL COMMISSION
Office of the Secretary, Boston

Community:	Form No:
Cambridge Mass. Cambridge MPA	O.C. I 3
Property Name: Berkeley St. & Pl.	

Indicate each item on inventory form which is being continued below.

Bibliography/References

- Cambridge Historical Commission. Survey of Architectural History
in Cambridge: Volume I, East Cambridge (1965), out of print.
Volume II, Mid Cambridge (1967), Cambridge, MA
Volume III, Cambridgeport (1971), Cambridge, MA
Volume IV, Old Cambridge (1973), Cambridge, MA
Volume V, Northwest Cambridge (1977), Cambridge, MA
- Cambridge Historical Society, Proceedings (1906-Present), Cambridge, MA.
- D.A.R., Winthrop Chapter, An Historical Guide to Cambridge (1907),
Cambridge, MA.
- Gillman, A. (ed.), Cambridge of Eighteen Hundred and Ninety-Six (1896),
Cambridge, MA.
- Paige, L.R., History of Cambridge (1877), Boston, MA.; Supplement
(1930), Boston, MA.
- Rand, C., Cambridge, U.S.A. (1964), New York, NY.
- Rettig, R.B., Guide to Cambridge Architecture (1969), Cambridge, MA.
- Stillman, W.J. (ed.), Poetic Localities of Cambridge (1876),
Cambridge, MA.
- Woods, R.A., and Kennedy, A.J. (Warner, ed.), Zone of Emergence
(1962), Cambridge, MA.
- Zaitzevsky, C., with the advice of the Review Committee members,
The Harvard University Study of Historic and Architectural
Properties in the Environs of Cambridge, (April 1983-December
1984), Cambridge, MA.

Staple to Inventory form at bottom

DISTRICT DATA SHEET

MAP #	HISTORIC NAME	STREET ADDRESS	DATE OF CONSTRUCTION	STYLE	C/NC
218,12	NA	1 Berkeley Pl.	1892	QA/SS/CR	C
218,10	NA	2 Berkeley Pl.	1892	SS/CR	C
218,13	NA	3 Berkeley Pl.	1892	SS/CR	C
218,17	NA	4 Berkeley Pl.	1910	NG	C
218,15	NA	5 Berkeley Pl.	1900	QA/SS/NT	C
218,26	NA	6 Berkeley Pl.	1914	QA	C
218,27	NA	7 Berkeley Pl.	1913	NT	C
218,30	NA	8 Berkeley Pl.	1931	CR/NG	C
216,24	Pryor/Brown House	1 Berkeley St.	1852	BI	C
170,33	NA	2½ Berkeley St.	1894	CR	C
216,23	Pryor/Howells House	3 Berkeley St.	1856	BI	C
217,5	Richard H. Dana House	4 Berkeley St.	1851-1852	BI	C
216,38,39	Wyeth/Allen House	5-7R Berkeley St.	1852	BI	C
217,4	NA	6 Berkeley St.	1853	BI	C
217,3	Henry Ware House	8 Berkeley St.	1859-60	MS	C
216,26	John Allyn House	11 Berkeley St.	1886	SS	C
217,2	NA	12 Berkeley St.	1881	SS/QA	C
216,21	NA	13 Berkeley St.	1898	SS	C
217,29	Lyman Williston House	15 Berkeley St.	1863	BI	C
217,1	NA	16 Berkeley St.	1905	MD	C

Berkeley Street and Berkeley Place National Register District con't Cambridge, Mass., Cambridge MRA 2.
DISTRICT DATA SHEET

MAP #	HISTORIC NAME	STREET ADDRESS	DATE OF CONSTRUCTION	STYLE *	C/NC**
216,30	NA	17 Berkeley St.	1863	QA	C
216,15	NA	19 Berkeley St.	1854-1855	BI	C
218,11	William Newell House	20 Berkeley St.	1856-1857	MS	C
216,33	NA	21 Berkeley St.	1854-1855	BI	C
218,8	John Fiske House	22 Berkeley St.	1877-1878	MS	C
216,32	NA	23 Berkeley St.	1854-1855	GR, BI	C
218,34	NA	24 Berkeley St.	1936	NG	NC

* GR=Greek Revival; BI=Bracketed Italianate; MS=Mansard; QA=Queen Anne; SS=Shingle Style; CR=Colonial Revival; NG=Neo-Georgian; NT=Neo-Tudor; MD=Modern.

** C=Contributing; NC=Non-Contributing.

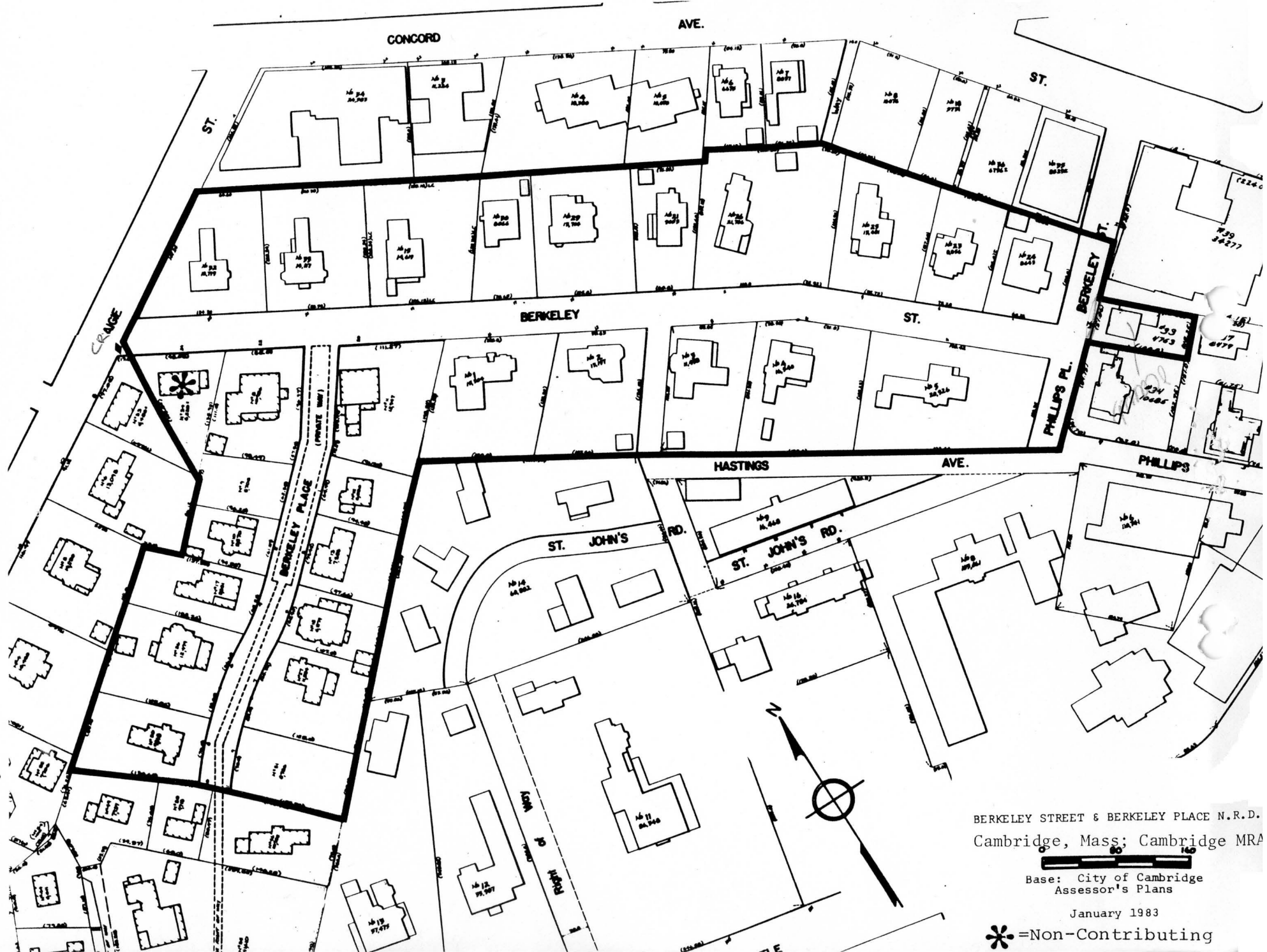

BERKELEY STREET & BERKELEY PLACE N.R.D.
 Cambridge, Mass; Cambridge MRA

Base: City of Cambridge
 Assessor's Plans

January 1983

* = Non-Contributing

Berkeley Street Historic District, Cambridge (Middlesex Co.), MA
(Boundary Increase)



20 Berkeley St.



4 Berkeley St.



7 Berkeley Pl.

United States Department of the Interior
National Park Service

National Register of Historic Places
Inventory—Nomination Form

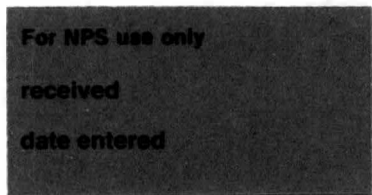

Continuation sheet

Item number

Page 17 of 17

Multiple Resource Area
Thematic Group

Name Cambridge Multiple Resource Area
State MA

Nomination/Type of Review

Date/Signature

161. Mead, Alpheus, House

~~Substantive Review~~ ✓ Keeper

William H. Brackham 4.13.82

Attest

162. Snow, Daniel, House

DOE/OWNER OBJECTION

~~Substantive Review~~ ✓ Keeper

William H. Brackham 4.13.82

Determined eligible

Attest

163. Wyeth, John, House

~~Substantive Review~~ ✓ Keeper

William H. Brackham 4.13.82

Attest

164. HOMER-LOVELL HOUSE

~~Substantive Review~~ Keeper

Wm. Duhon 12/22/83

Attest

165. Reversible Collar
Company Building

~~Substantive Review~~ Keeper

Beverly Boyd 9.27.85

Attest

50yr 166. Ash Street Historic District (Boundary Increase)

~~Substantive Review~~ Attest

TS

167. Berkeley Street Historic District (Boundary Increase)

Entered in the National Register ✓ Keeper

Melamed Byers 5-19-86

Attest

168. Bertram Hall at Radcliffe College

Entered in the National Register ✓ Keeper

Melamed Byers 5-19-86

Attest

169. Bennink-Douglas Cottages

Entered in the National Register ✓ Keeper

Melamed Byers 5-19-86

Attest

170. Brabrook, E. H., House

Entered in the National Register ✓ Keeper

Melamed Byers 5-19-86

Attest